

Industrial Road Site

El Dorado, Arkansas

Select Site Profile

78.5 acres

Your time and money are better spent on sites that have met our 50-point criteria for certification. We're sure you will be confident with the certainty and responsiveness **Select Site** offers your project.



General Information & Site Characteristics	
Location:	El Dorado
Previous Use:	Timber
Fire Rating:	Class 3
Distance to Fire Station:	3.1 mi
Distance to Interstate or 4-Lane:	1 mi to US 167 55 mi to I-20
Distance to Air:	10 mi to Regional 90 mi to Monroe, LA 120 mi to Little Rock National Airport
Distance to Rail:	0.25 mi

Taxes	
Sales Tax:	8.25%
Property Tax:	40.9 Mills/1,000 x 20%
Methods of Assessment:	Value x 20% x Millage = Annual Property Tax
State Taxation Summary:	Provided

Utilities
All local utility contact information provided. When applicable, service upgrade cost estimates and other developmental estimates are provided.

Environmental		Maps	
√	Wetlands Screening	√	Topographic
√	Floodplain Map	√	Utilities
√	Historical Survey	√	Surrounding Uses
√	Environmental Phase I	√	Road Infrastructure
√	Soils Report/Boring Logs	√	Easements
12' to 22'	Water Table Depth	√	USGS Quadrangle
		√	Zoning

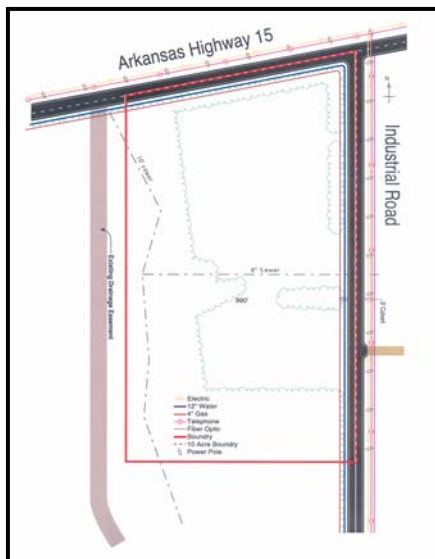

For more information, please contact:

Russell Harris or Chris Marsh
 Entergy's Teamwork Arkansas
888.301.5861
www.TeamworkArkansas.com
 or
 Don Wales
 El Dorado Industrial Development Corporation
 870.863.6115